

الجمهورية اللبنانية
وزارة الأشغال العامة والنقل
مصلحة إستثمار مرفأ طرابلس

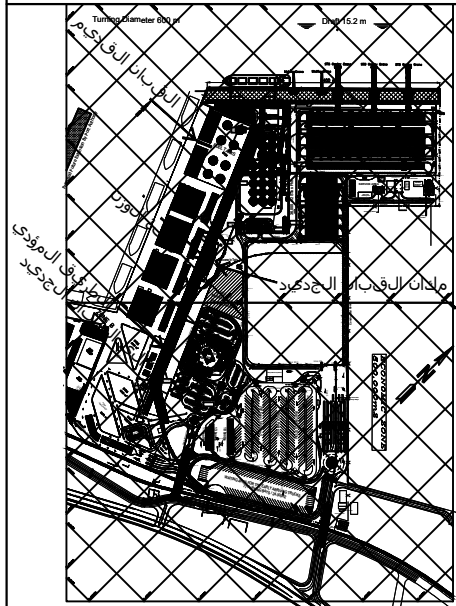

مشروع نقل قبان الفحرم
في حرم مرفأ طرابلس
الى المنطقة الخلفي
للمستودع رقم 2

ملاحظات

Project : Prefab. Offices
Electrical & Mechanical dwgs
Scale 1/50

لوحة رقم 3
خريطة غرفة الوزن

إعداد: الدائرة الفنية في
مرفأ طرابلس

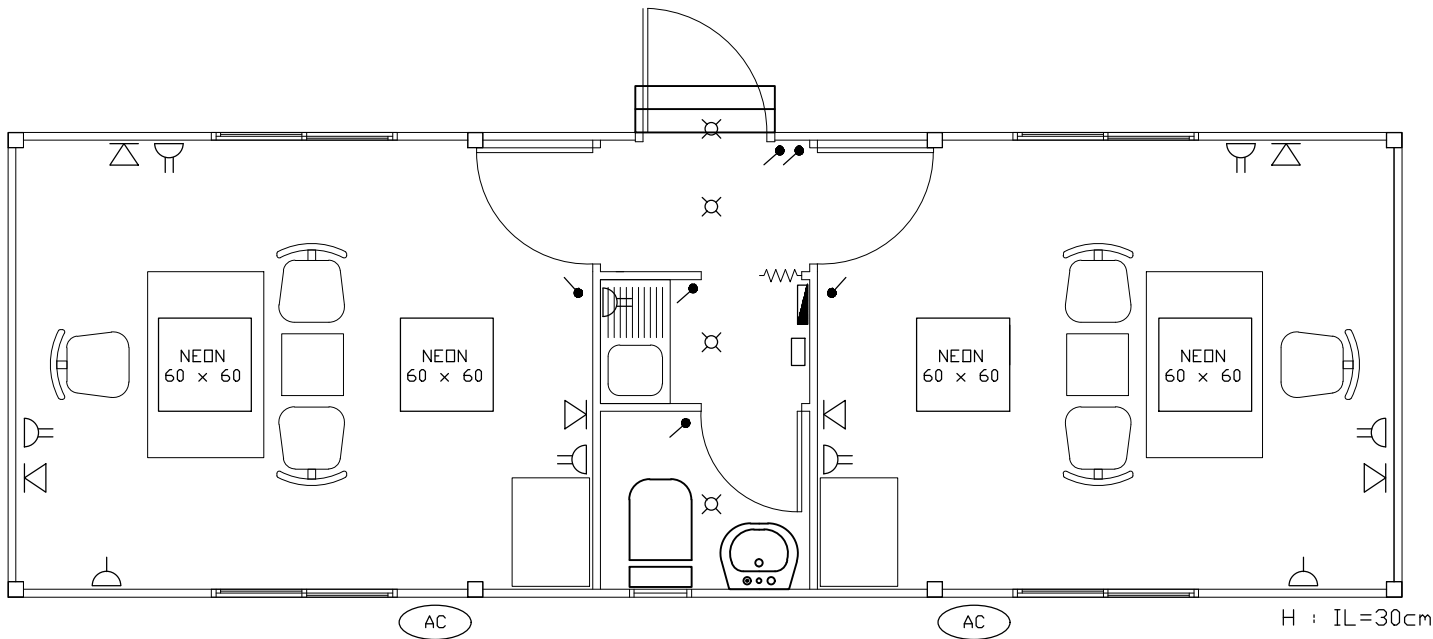

ELECTRICAL LAYOUT

Remark:

The contractor must included in his lump sum price of weigh room, all electrical works as per above drawings, (With joining with existing network, with all related pipes, cables, and manholes, as directed by the Engineer.)

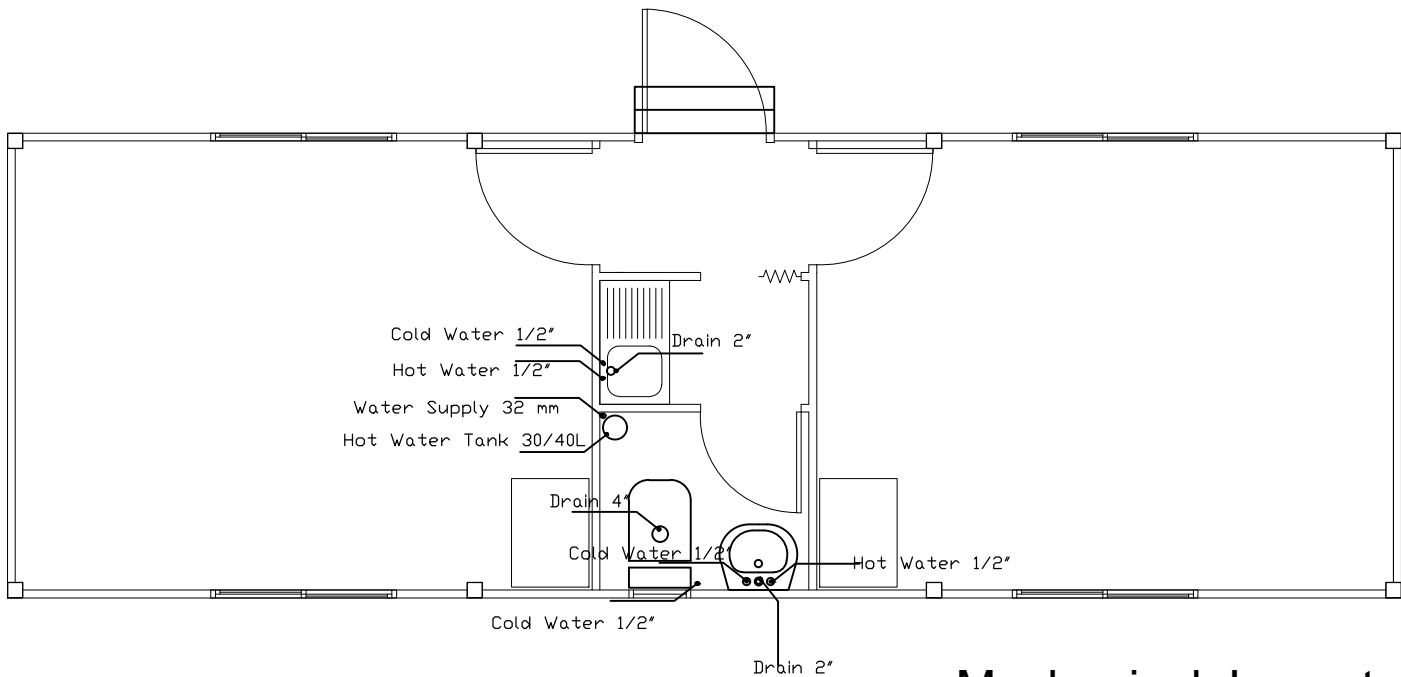

Mechanical Layout

Remark:

The contractor must included in his lump sum price of weigh room, all mechanical works as per above drawings, (With joining all drains outlets with existing network, with all related pipes and manholes, as directed by the Engineer.)

- Panel Board
- Data Cabinet
- Socket Outlet
- Switch
- Telephone & Data
- Lighting Fixture

ppr Hot Water Tank 30-40 L

- 9 m 25
- 3 m 32
- 7 Elbows 25x1/2
- 6 Elbows 25mm
- 1 T 32x25x25mm
- 4 Coupling 25mm

pvc

- 2 T y 4"
- 2 Reducer 4"x2"
- 3 Elbows 2"
- 4 Elbows 4"
- 2m 4" pipe
- 6m 2" pipe
- 4 Open Elbows 2"